

DETAIL A

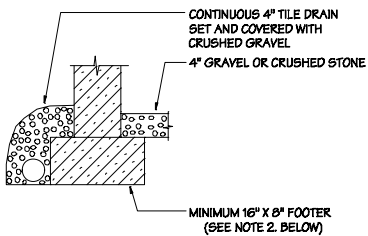

DETAIL B

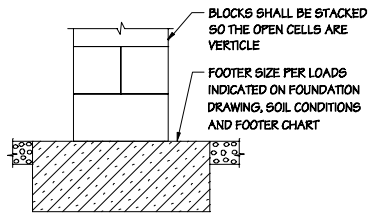

DETAIL C

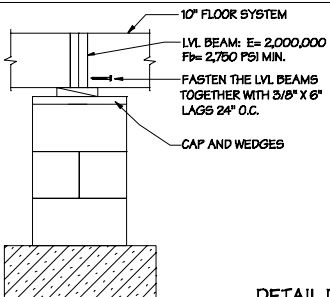

DETAIL D

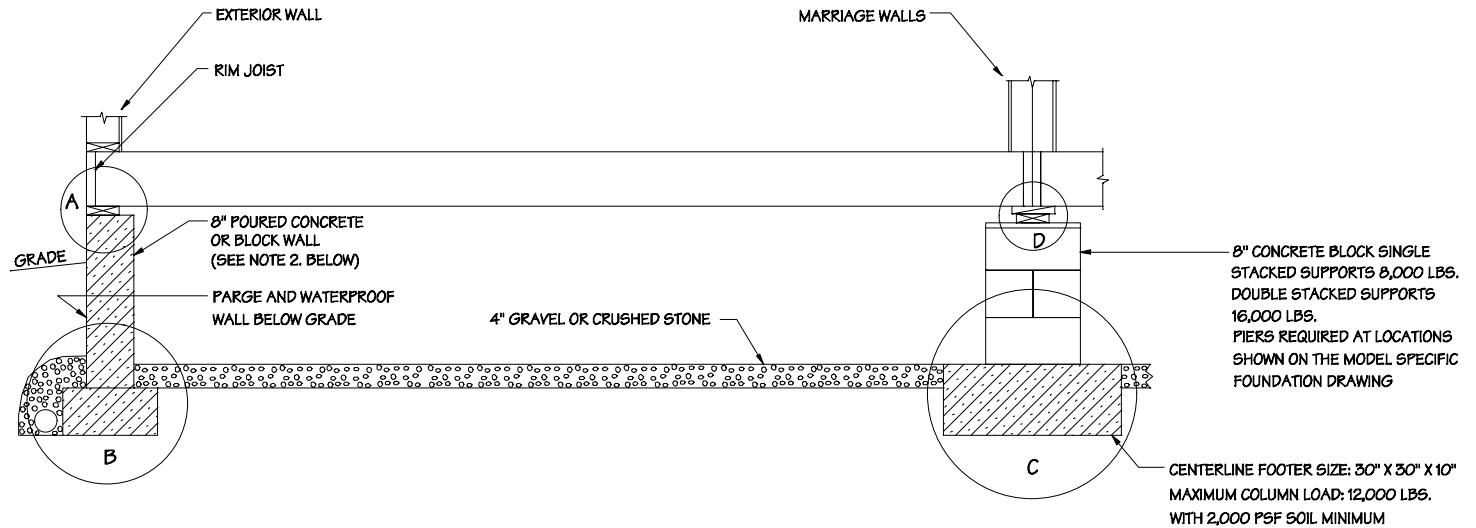

MINIMUM CONCRETE STRENGTH
FOOTERS: 3,000 PSI
FOUNDATION WALL: 3,000 PSI

Manufactured Housing Enterprises, Inc.
09302 State Route 6 Bryan, Oh. 43506

SETUP MANUAL

CRAWLSPACE CROSS SECTION TYPICAL

Date: 6-8-99 Rev: 7-14-15 By: JB

NOTES: (SPANS ARE FOR 30 PSF GROUND GROUND SNOW LOAD)

1. FOOTINGS TO BE DESIGNED FOR ACTUAL SOIL CONDITIONS OF THE SITE BY EITHER AN ENGINEER OR ARCHITECT. CONSIDER FROST LINES.
2. THE LOCAL JURISDICTION MAY REQUIRE THICKER FOUNDATION WALLS AND OR FOOTING. IT IS THE BUILDERS/ DEALERS RESPONSIBILITY TO COMPLY WITH ALL LOCAL CODES.
3. MAXIMUM SPAN OF MARRIAGE WALL OPENING WITHOUT COLUMN IS 47".
4. MAXIMUM SPAN OF COLUMN SUPPORTS IS 10'-5".
5. MAXIMUM SPAN OF COLUMN SUPPORTS WITH FLOOR LOAD ONLY IS 12'-10".
6. CONCRETE MASONRY BLOCKS SHALL BE MORTARED PER LOCAL CODE REQUIREMENTS. MORTAR IS TO BE TYPE M OR S PER ASTM C-90.